



A VISION POWERED BY HERITAGE

Widely known for always being one step ahead by choosing the most ideal locations in Egypt, and by anticipating the next crowd puller. Their vision has caught one of the most beautiful locations in Egypt to rebuild, only this time, quite perfectly.



South Sinai

A perfect costal location, from the ancient times.



Culture

Explore a new inspirational lifestyle introduced by Bedouins and get a taste of their golden heritage.



Wild Life

The clearest way to the universe over and above the mountains of Sinai's golden sands.



Coral Life

Marine reef beauty giving life to the sea's most exquisite species.



Ras Sudr

A refined location, rediscovered by the industry's finest...



Bay (noun):

An inlet along the shore line where the land curves inwards, surrounded by hills, creating a shield from wind, resulting in calm crystal clear waters.



Bayside.
RASSUDR



Redefined Philosophy

An ideal paradise getaway reconstructed to delight your senses with a unique concept of design planned to choose nature over form; to maximize exotic natural exposure in your vacation and to combine luxury with a simple mindset.

A wide-angle photograph of a winding asphalt road through a desert valley. The road curves from the bottom left towards the center. The landscape is arid with sparse, dry vegetation. In the background, large, rugged mountains are bathed in a warm, golden light, suggesting a sunrise or sunset. The overall mood is serene and peaceful.

Relaxing Road Trip

No need to contemplate when you're just a drive down a 2-hour road trip along Egypt's golden mountains to prepare you for a place that requires no expectations from you. A place that unclutters your soul.



Recreational Architecture

Architecture designed to combine together a set of flexible and trendy indoor and outdoor facilities divided into active recreation and passive recreation.

Active recreation refers to an equipped individual or team activity that require the use of special facilities, courses, fields, or equipment such as Handball, fitness and yoga courses. While passive recreation refers to activities that do not require prepared spaces and depend on natural resources such as birdwatching, snorkeling, fishing, and hiking.

A woman with curly hair, wearing a vibrant blue dress and several bracelets, is lying on her back on a large, light green beanbag chair. She is smiling with her eyes closed, her arms raised behind her head. The chair is on a wooden deck. To her left is a bright blue beanbag chair, and to her right is a lime green one. In the background, there's a wooden railing with a rope, and beyond that, a clear blue ocean with a small boat visible in the distance. The scene is bright and sunny, suggesting a tropical or coastal setting.

Relived Hideaways

An uninterrupted train of thoughts created by the sounds of calming waves and the wind blowing through the palm trees where time passes effortlessly, and moments are forever cherished and relived any time.

A man and a woman are relaxing in an infinity pool. The man is on the left, looking towards the woman on the right. They are both in the water, which is crystal clear and reflects the sky. The pool is situated on a cliffside, overlooking the ocean. There are some tropical plants and a building visible in the background.

Released Soul

A new viewpoint where negativity goes below the horizon and your soul is elevated naturally above crystal-clear water.

A mindset automatically changed when you are deep into nature breathing fresh air at a new destination. Making it the perfect spot to recover from the city's distractions and feel alive again.

A woman with long dark hair, wearing a red one-piece swimsuit, is sitting in a large, round, woven basket. The basket is filled with tropical fruits, including a whole pineapple, a glass of orange juice, sliced watermelon, and other fruits. She is holding a small white flower in her hand and looking down at it with a smile. The background is a clear, turquoise lagoon with a sandy beach and palm trees in the distance.

Resort Living

Enjoy a mixture of relaxation and pleasure operating all year long by a welcoming group of staff and security that will provide you with royal treatment at an exotic touristic attraction.

Master Plan





- 1 GRAND DECK
- 2 FLOATING DECK
- 3 INFINITY DECK
- 4 BAYFRONT VILLAS
- 5 FLYING DECK
- BUILDING (A)
- BUILDING (B)

- The Grand Entrance
- Infinity Pool
- Hotel Cabanas
- Fitness Deck
- Yoga Deck
- Restaurant
- Events & Gathering Deck
- Photo Deck
- Bay Valley
- Bay Deck

- Relaxation Deck
- Bite Deck
- Waterfall Deck
- Cafe
- Pocket Gardens
- Play Deck
- Jungle Walk
- Swimmable Lagoon
- Handball Deck



Rediscovered On Deck

Whether you prefer to jump in the water or like to take it slow, be sure that you will rediscover yourself from a new concept of overwater living finally brought to Egypt, the Maldivian way.
Roaming through a tropical island of wood and stone evoking nature's own vital organic existence finally settling on a water bed of tranquility.

Which Deck Are You?

THE
GRAND
DECK

THE
FLOATING
DECK

THE
INFINITY
DECK

THE
FLYING
DECK

THE
BAY
DECK

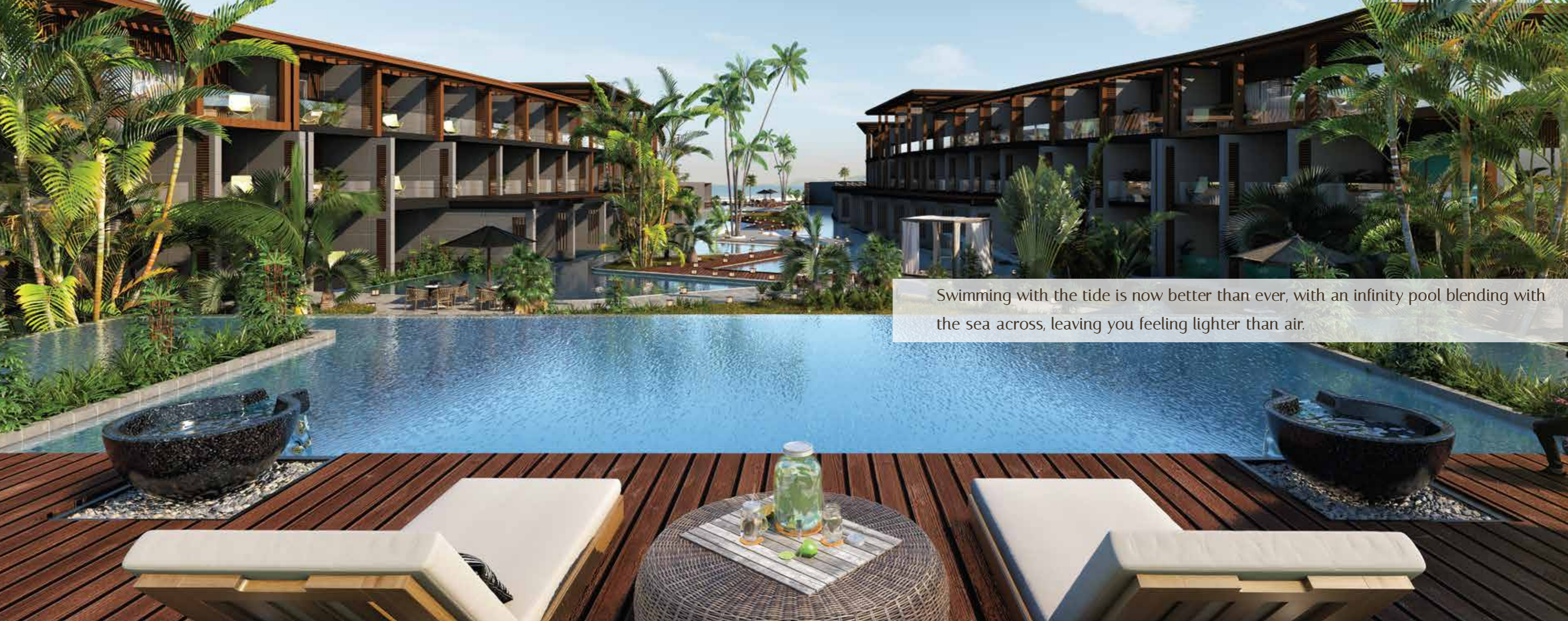

Swimming with the tide is now better than ever, with an infinity pool blending with the sea across, leaving you feeling lighter than air.

THE GRAND DECK

1

Your royal entrance and highest deck of the project, allowing panoramic views of the beautiful shades of blue, designed to portray the element of lighting and shading giving a sense of transparency with nature allowed through the double heightened ceilings.





Bayshore
CALLED





Health Club

A recreational state of mind in the form of fluffy bathrobes and slippers providing beneficial wellness.

Services joined together to ensure a refreshing, de-stressing environment, that will leave you revitalized.

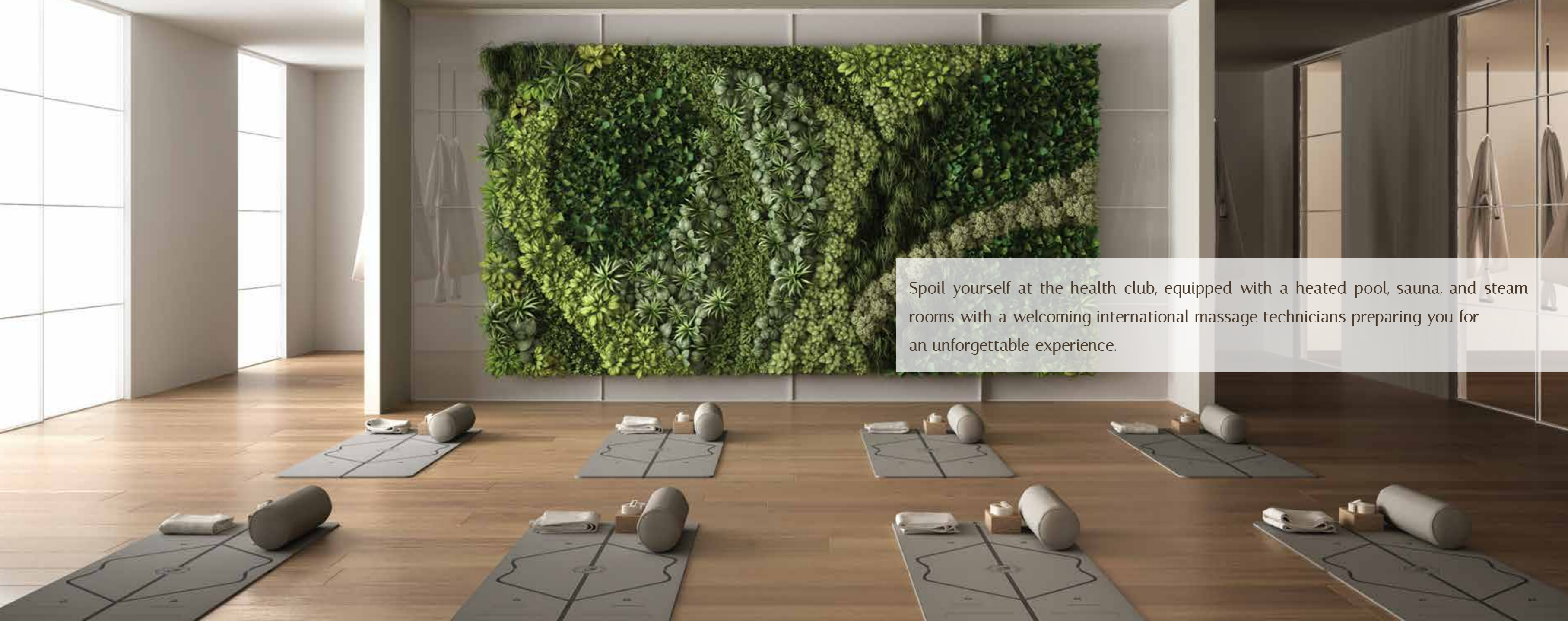

Spoil yourself at the health club, equipped with a heated pool, sauna, and steam rooms with a welcoming international massage technicians preparing you for an unforgettable experience.



Fine Dinning

Your favorite stop to experience the fine art of cooking, or choose between on demand cafeteria and restaurants, or the pleasure of an open-buffet with a superior high quality food selection.



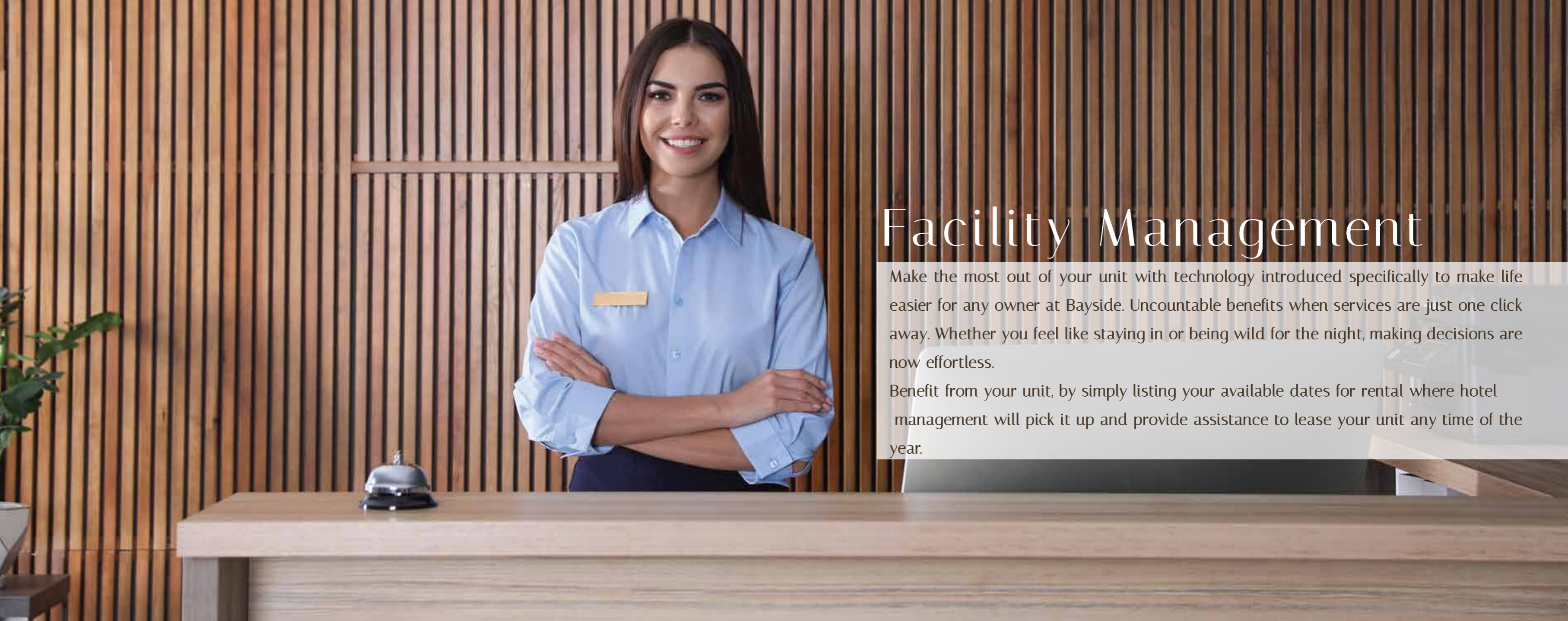

Facility Management

Make the most out of your unit with technology introduced specifically to make life easier for any owner at Bayside. Uncountable benefits when services are just one click away. Whether you feel like staying in or being wild for the night, making decisions are now effortless.

Benefit from your unit, by simply listing your available dates for rental where hotel management will pick it up and provide assistance to lease your unit any time of the year.

A high-angle photograph of a wooden floating deck extending into clear turquoise water. The deck is made of dark brown wooden planks laid in a parallel pattern. The water is crystal clear, showing ripples and reflections. The deck curves slightly to the right. In the upper right, there is a white square box containing the text 'THE FLOATING DECK' in a serif font. Below this box is a small white square containing the number '2' in a teal font. In the lower right, there is a paragraph of text in a white sans-serif font.

THE FLOATING DECK

2

The second highest residential deck of the project allowing a crystal level of water to go under the chalets located in this area.



Swimmable Lagoon

Accessed directly from your own front private deck located on the ground floor or an elevated tropical and breezy rooftop overlooking the Bay Valley to heaven.



A floating feeling allowing your soul to experience the ability to touch water anytime of the day directly from your backyard.



Bay Valley

A stroll down a wooden elevated walkway which takes you directly to the bay.
A central group-seating area at the end of the lake to have some side talks with your friends and family while surrounded by water and sipping on some refreshing cocktails.



THE
INFINITY
DECK

3

A closer deck to the bay joining Resort Cabanas together for an unforgettable overwater hospitality experience.





Enjoy the privilege of jumping first thing in the morning in your own water front Cabana operating all year long and easily booked through an app for the easiest hospitality hideaway solutions.

A wide-angle photograph of an infinity pool overlooking the ocean. The pool's edge is perfectly aligned with the horizon, creating a seamless transition between the turquoise water of the pool and the deep blue of the sea. In the middle ground, a man and a woman are swimming together, their bodies partially submerged. The man is on the left, looking towards the woman on the right. The sky is a pale, hazy blue, and the overall atmosphere is serene and romantic. On the right side, there are lush green tropical plants, including what appears to be a frigatebird tree with white flowers.

Infinity Pool

Endless shades of blue blending together for an unforgettable pool experience with breath taking views, and in-water food and beverage services.

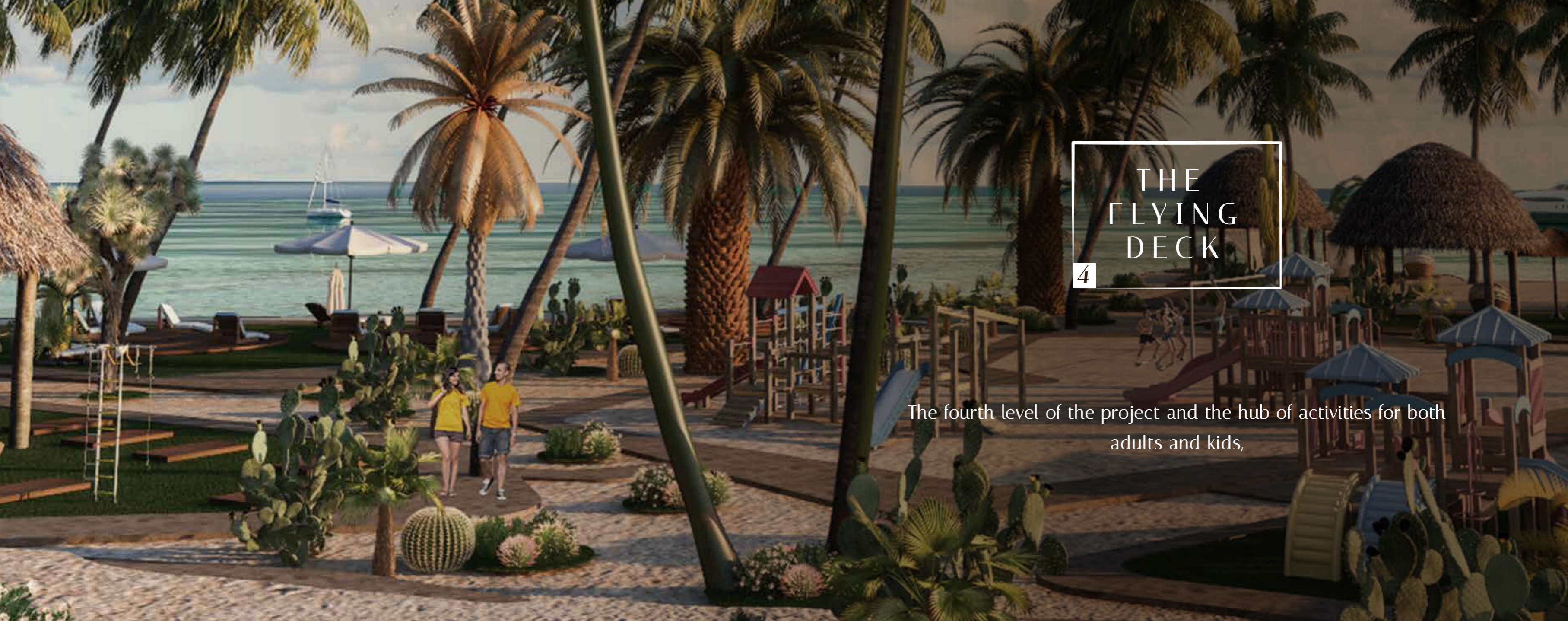

THE
FLYING
DECK

4

The fourth level of the project and the hub of activities for both adults and kids,



A blend of The Infinity pool's waterfall into the bay, The Flying Deck. Enjoy the cascade sounds of water while relaxing and sipping on a tropical juice or if your energy levels are up then choose from a list of uplifting sea activities.



Outdoor Fitness

Join the crew for some on the beach group activities ranging from Handball, outdoor fitness to Yoga and meditation classes for some renewable energetic vibes.



Beach Ball

Team up with the crew for an exciting form of workout while soaking up some sun or drop off your kids for some useful training time with their favorite coaches.



Kids Park

Designed to attract any child's attention for hours with a fun yet safe environment to be dropped at while you get some errands done or through a long relaxing spa time.

A vibrant tropical resort scene. In the foreground, a paved path leads through lush greenery, including large banana leaves and various tropical plants. To the left, a thatched umbrella stands over a lounge area with white fabric-covered seating. In the center, a man and a woman are walking hand-in-hand along the path. To the right, several round, white, cushioned lounge chairs are arranged on a grassy area. In the background, more thatched huts and tall palm trees are visible under a bright, slightly hazy sky. The overall atmosphere is peaceful and idyllic.

Jungle Walk

Choose your perfect wished for spot to soak up some sun while having alone time to rewind the effects of modern living. Or take a wild stroll through The Jungle walk designed to evoke your senses using nature's own sounds and aesthetics.



Food Trucks

A necessary food stop to serve a deck filled with activities meant to regenerate your soul and body. Fit in a healthy snack or famous delicious dishes through your exciting day.



The peak of heavenly picture perfect views generating the best occasional events and gatherings for an unforgettable celebration and lasting memories.

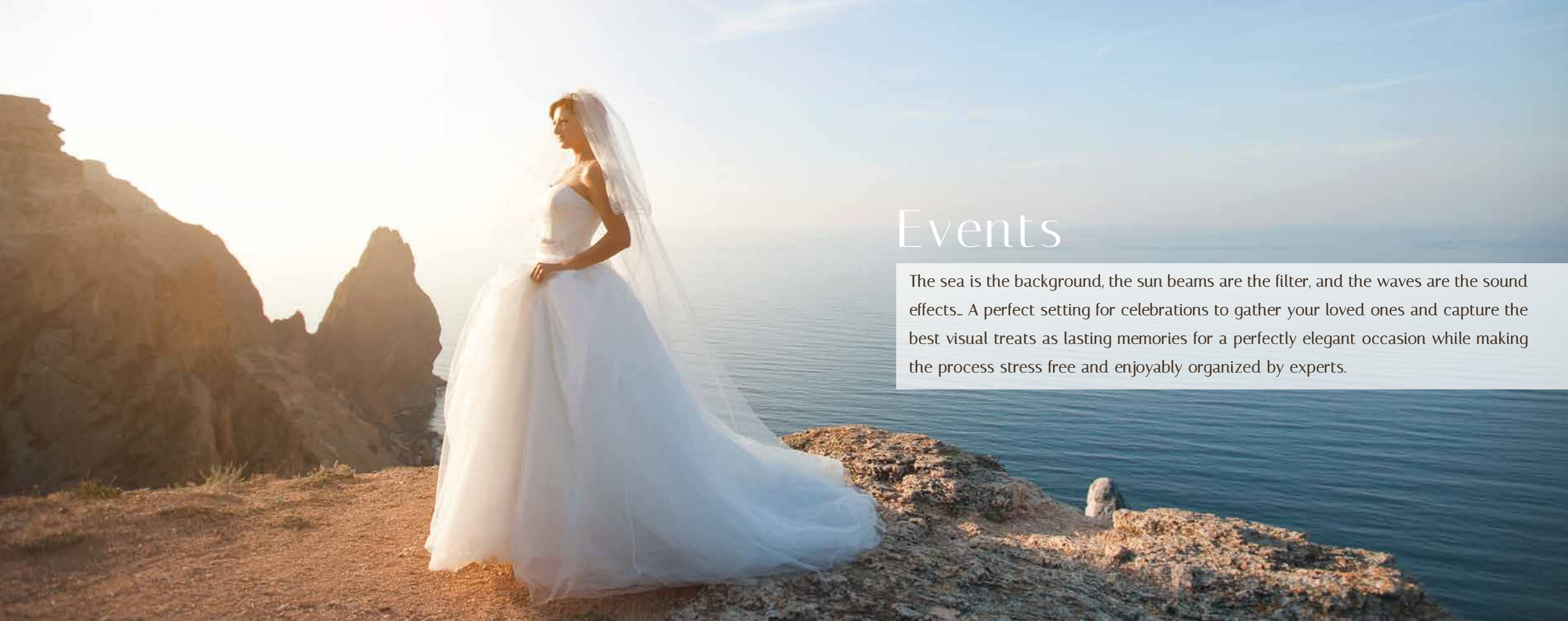

Events

The sea is the background, the sun beams are the filter, and the waves are the sound effects... A perfect setting for celebrations to gather your loved ones and capture the best visual treats as lasting memories for a perfectly elegant occasion while making the process stress free and enjoyably organized by experts.

A photograph of three people practicing yoga on a beach at sunset. They are sitting in a lotus position with their hands raised in a prayer position. The scene is bathed in the warm, golden light of the setting sun, with palm trees and the ocean in the background.

Wellness

Fade into the beautiful benefits of nature, feel the sand between your feet, and soak up some vitamin D from the sun on your skin. Exercise outdoors with a group of professionals for some positive restoration techniques of Yoga and Fitness.

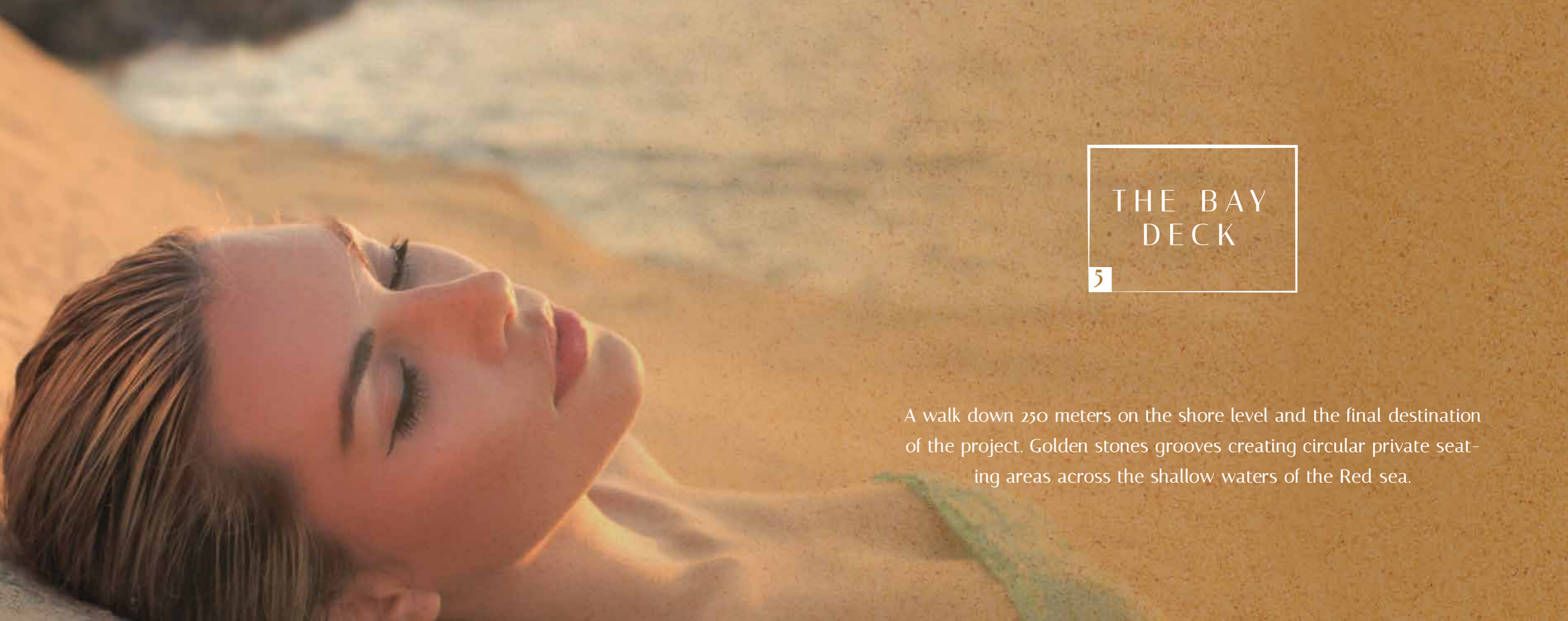

THE BAY DECK

5

A walk down 250 meters on the shore level and the final destination of the project. Golden stones grooves creating circular private seating areas across the shallow waters of the Red sea.



Find your cocoon by the sea and have a siesta any time of the day to clear your head by nature's vibrations while swinging through the wind.



Spark After Dark

If you live for the night, then you can become a star for the first time in Ras Sudr, you have the choice to catch some fun and move to some beats under the moon.



Bayside.
RASSUR

Outdoor Cinema

The perfect date night watching a movie under the stars on a cozy wooden deck elevated to catch a breeze yet equipped with blankets to keep you warm or maybe use as picnic spreads for the best Instagram-able moments.



Nightlife

A nightlife organized by experts to operate all year, with occasional themed parties and beach music festivals to offer you an unforgettable buzz.

Interior Design Philosophy





Choose from a set of two perfectly.
balanced interiors that reflect your personality.



Fully Furnished units

Perfectly depict the luxuriousness and spaciousness of the space in its distinctive way. Giving an edgy raw look and feel to conceptualize the lavish maldives bungalow life.

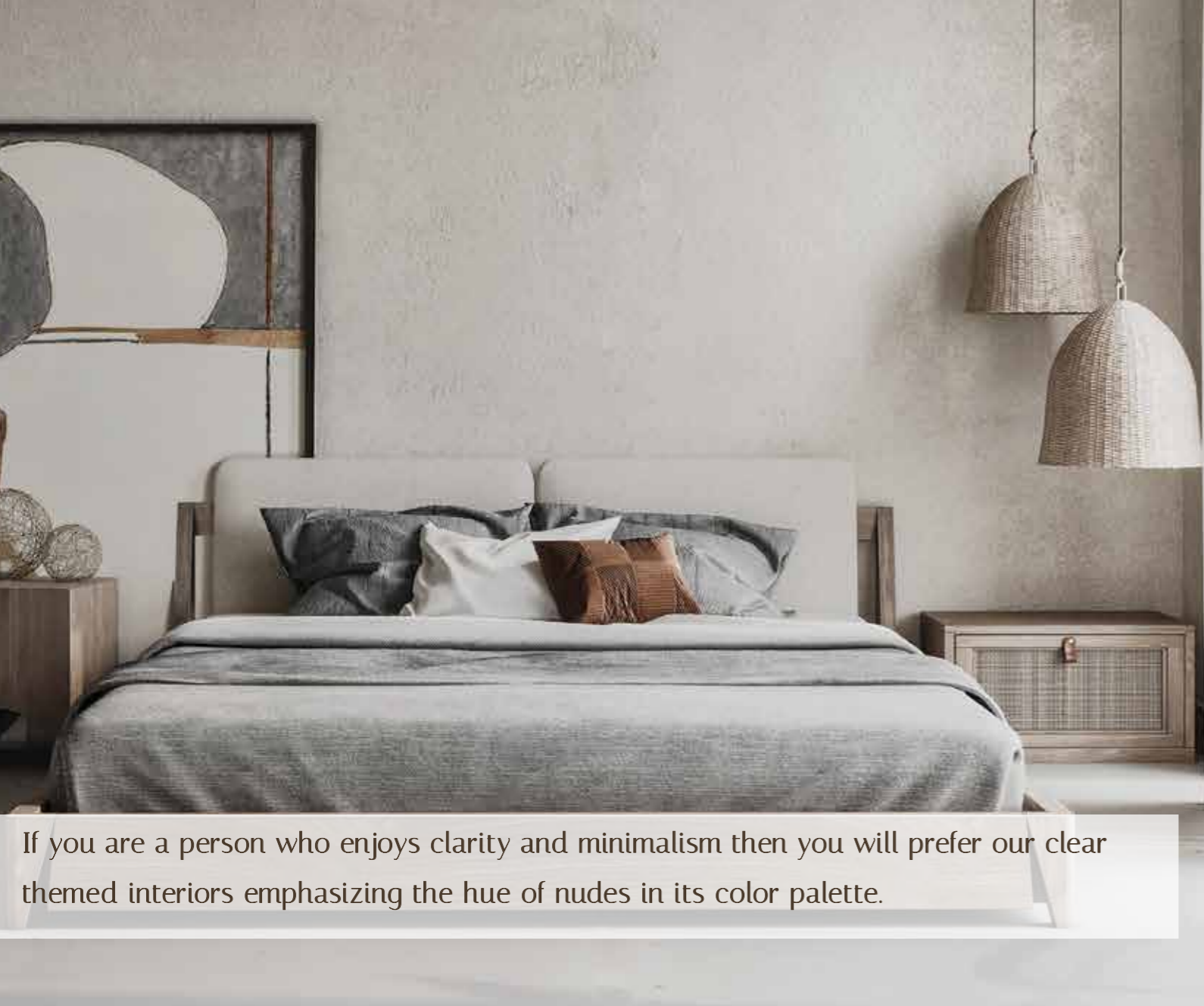

If you are a person who enjoys clarity and minimalism then you will prefer our clear themed interiors emphasizing the hue of nudes in its color palette.

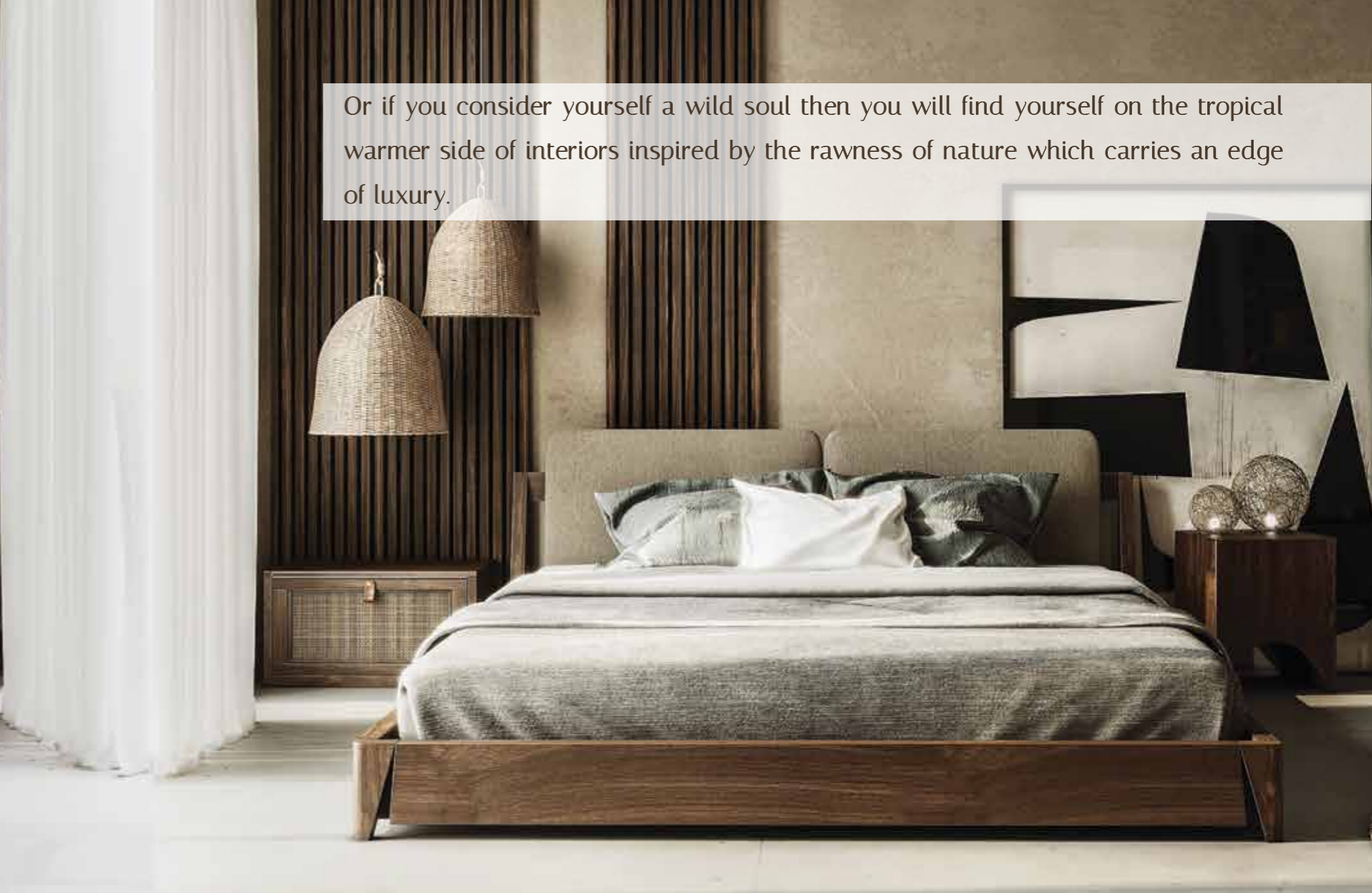

Or if you consider yourself a wild soul then you will find yourself on the tropical warmer side of interiors inspired by the rawness of nature which carries an edge of luxury.









Technical Unit Layout



Hotel Cabana

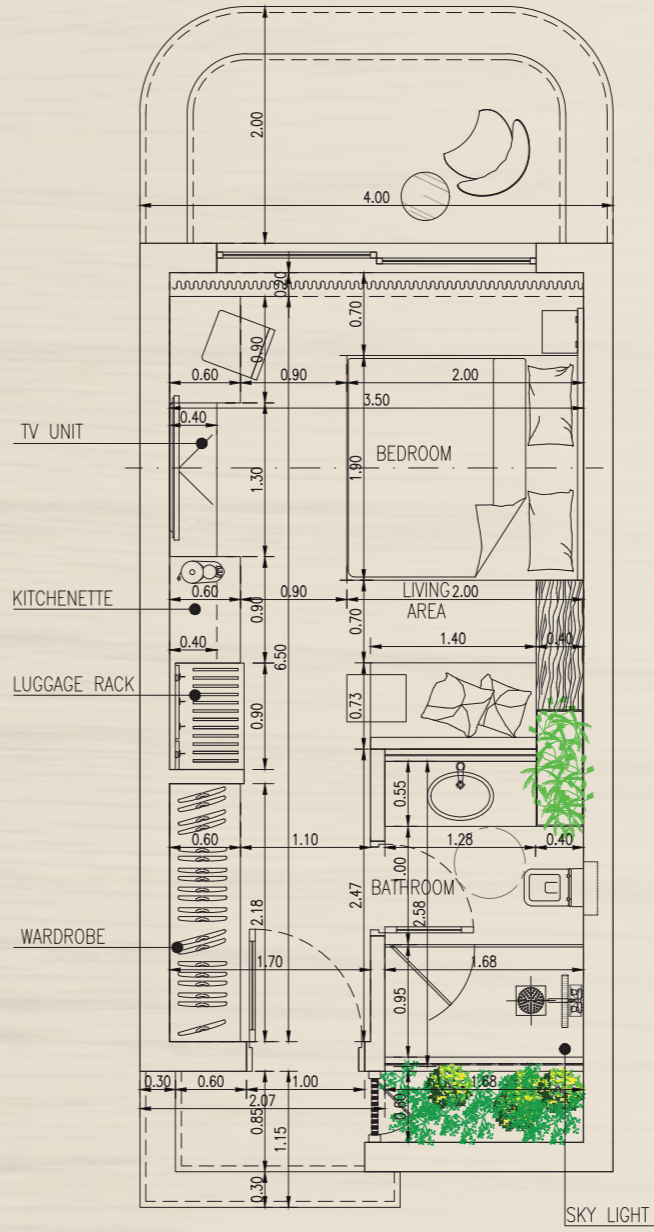

CRYSTAL
FRONT CHALET
GROUND FLOOR
75 M²

Terrace: 4.5x2.1 m²

Bathroom: 2.5x2.9 m²

Bedroom: 4.3x3.4 m²

Wardrobe: 0.7x2.0 m²

Kitchenette: 0.8x1.5 m²

Private Pool: 15 m²

Living Room: 4.4x2.9 m²



CRYSTAL
FRONT CHALET
GROUND FLOOR
75 M²

Terrace: 4.5x2.1 m²

Living Room: 4.4x2.9 m²

Bedroom: 4.3x3.4 m²

Bathroom: 2.5x2.9 m²

Kitchenette: 0.8x1.5 m²

Wardrobe: 0.7x2.0 m²



SKY CHALET
FIRST FLOOR
75 M²

- | | | | |
|--------------|------------------------|--------------|------------------------|
| Terrace: | 4.5X2.1 m ² | Living Room: | 4.4X2.9 m ² |
| Bedroom: | 4.3X3.4 m ² | Bathroom: | 2.5X2.9 m ² |
| Kitchenette: | 0.8X1.5 m ² | Wardrobe: | 0.7X2.0 m ² |



SKY CHALET

SECOND FLOOR

75 M²

Terrace: 4.5X2.1 m²

Living Room: 4.4X2.9 m²

Bedroom: 4.3X3.4 m²

Bathroom: 2.5X2.9 m²

Kitchenette: 0.8X1.5 m²

Wardrobe: 0.7X2.0 m²



Bayside.
R A S S U D R

Development Consultant
iVERSION
MANAGING AND DEVELOPMENT SERVICES

Architectural Consultant
YBA
ARCHITECTS

Interior Design Consultant
 **Hany Saad**
Innovations™